

AN ORDINANCE AMENDING KING COUNTY DISTRICTING (ZONING) RESOLUTION NO. 18801, AS AMENDED BY AUTHORIZING A PLANNED UNIT DEVELOPMENT ON CERTAIN PROPERTY.

SHERWOOD DEVELOPMENT COMPANY

WHEREAS (a/k/a Timberlane (Covington)) has petitioned King County requesting approval of a planned unit development on property described in said petition and all legal requirements have been performed; and

WHEREAS the Department of Planning has transmitted to the King County Council, King County, Washington, a copy of the Department's findings and action recommending approval of this planned unit development;

NOW, THEREFORE BE IT ORDAINED that the King County Council does hereby adopt the findings and recommendation of the Department of Planning as its own and does hereby approve the final plans for Planned Unit Development as shown in Exhibit(s) CC and DD attached hereto and made a part hereof as located hereon and legally described herein which lies within Section (s) 29 & 30 Township 22 Range 6 E.W.M., on Area Map(s) W-45 a part of the District (Zoning) Map.

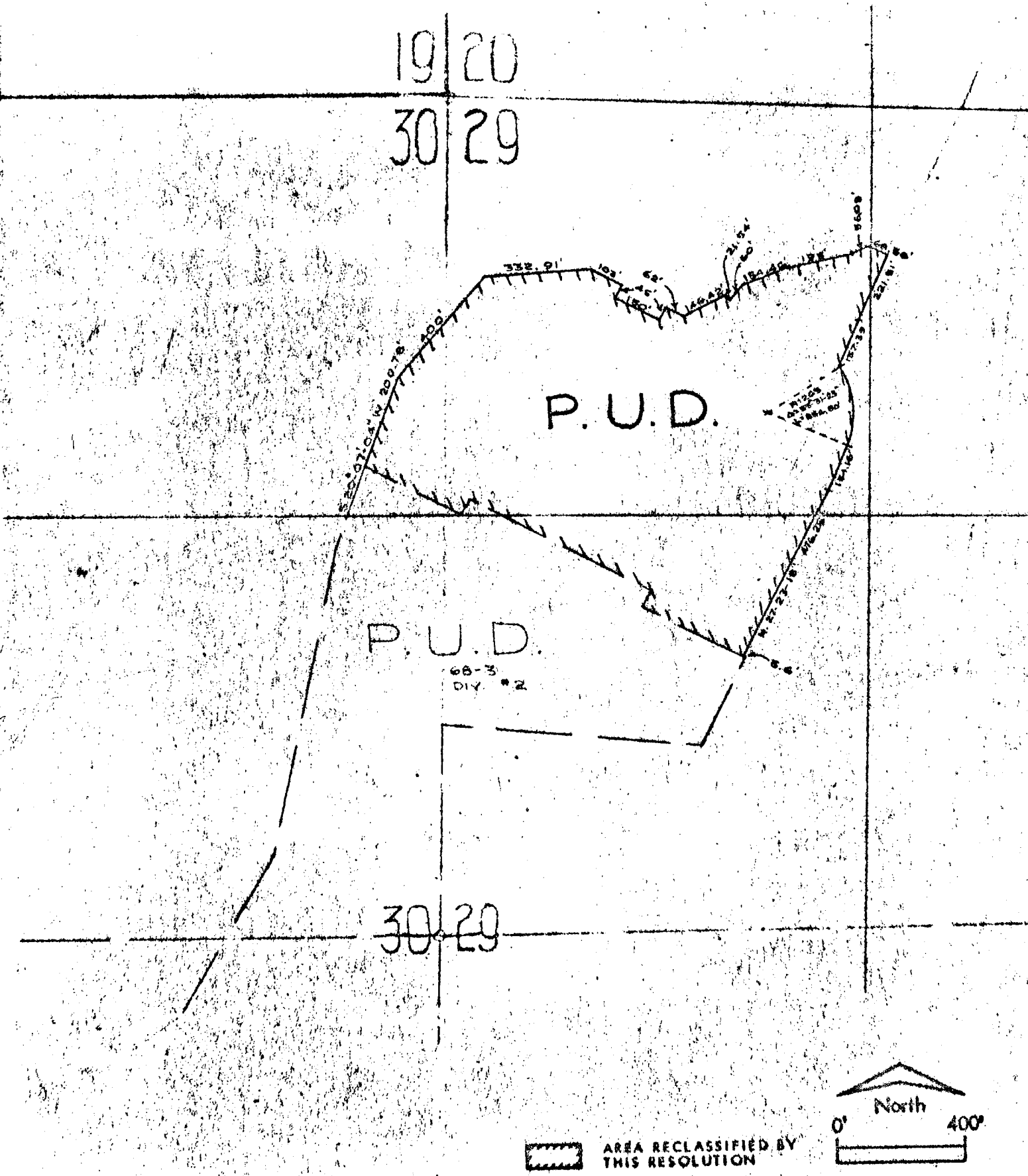

LEGAL DESCRIPTION:

A portion of the east half of Section 30 and a portion of the west half of Section 29, Township 22 North, Range 6 East, W. M., King County, Washington described as follows:

Beginning at the most northerly corner of Timberlane Estates, Division No. 2 as filed under Auditor's File No. 6464003 on the 28th day of January, 1969, in Volume 88 of Plats, at pages 41-42-43, records of said King County, Washington; thence along the northerly line of said Timberlane Estates, Division No. 2 the following courses: South $62^{\circ}36'42''$ east 332.50 feet; thence at right angles north $27^{\circ}23'18''$ east 59.50 feet; thence at right angles south $62^{\circ}36'42''$ east 624.50 feet; thence at right angles south $27^{\circ}23'18''$ west 59.50 feet; thence at right angles south $62^{\circ}36'42''$ east 350.20 feet to a point on said northerly line from which the most easterly corner of said Timberlane Estates, Division No. 2 bears south $62^{\circ}36'42''$ east 5.96 feet along said northerly line; thence at right angles north $27^{\circ}23'18''$ east 476.28 feet; thence north $23^{\circ}19'18''$ east 154.16 feet to a point of curve; thence along the arc of a curve to the left having a radius of 265.00 feet through a central angle of $55^{\circ}31'23''$ a distance of 256.80 feet to a point from which the center of said curve bears south $57^{\circ}47'55''$ west 265.00 feet; thence north $23^{\circ}19'18''$ east 157.39 feet; thence north $24^{\circ}32'00''$ east 221.51 feet; thence at right angles north $65^{\circ}28'00''$ west 68.56 feet; thence south $66^{\circ}30'00''$ west 56.08 feet; thence south $78^{\circ}00'00''$ west 195.00 feet; thence south $69^{\circ}30'00''$ west 154.46 feet; thence south $40^{\circ}00'00''$ west 60.00 feet; thence north $50^{\circ}00'00''$ west 21.54 feet; thence south $63^{\circ}04'27''$ west 146.42 feet; thence north $62^{\circ}36'42''$ west 62.00 feet; thence at right angles south $27^{\circ}23'18''$ west 45.00 feet; thence at right angles north $62^{\circ}36'42''$ west 150.00 feet; thence at right angles north $27^{\circ}23'18''$ east 45.00 feet; thence at right angles north $62^{\circ}36'42''$ west 103.00 feet; thence south $86^{\circ}24'22''$ west 332.91 feet; thence south $40^{\circ}34'04''$ west 400.00 feet; thence south $20^{\circ}07'04''$ west 200.78 feet to the point of beginning. Less County roads.

Subject to reservations and easements as recorded under Auditor's File No.'s 6306662, 4448558, 3688378.

INTRODUCED and read for the first time this 9th day of

June, 1969.

PASSED by the Council at a regular meeting thereof on the _____

day of JUN 16 1969, 1969.

Chairman of the County Council

ATTEST:

Clerk of the Council

APPROVED this _____ day of _____, 1969.

King County Executive